



## 9<sup>th</sup> ORPHEUS Conference

# Creating Career Opportunities for PhDs in Life and Health Sciences

# PROGRAM BOOK

Faculty of Biology and Medicine, University of Lausanne  
University Hospital  
April, 3<sup>rd</sup>-5<sup>th</sup> 2014  
Lausanne, Switzerland

orpheus

ORganisation of PhD Education in Biomedicine and Health Sciences in the  
EUropean System

Unil

UNIL | Université de Lausanne



Faculté de biologie et de médecine

# SPONSORS

We kindly thank our sponsors:

Contact Group for Research Matters (KGF)



We would additionally like to thank EMTRAIN for their generous support of 5 student bursaries.



In collaboration with the Association of PhD Candidates and Assistants at the Faculty of Biology and Medicine (ADAS) of the University of Lausanne & the Lausanne Tourism Office, Switzerland



THE 9<sup>TH</sup> ORPHEUS CONFERENCE WAS GENEROUSLY SUPPORTED BY



Faculté de biologie et de médecine

# Organisation of PhD Education in Biomedicine and Health Sciences in the European System

## 9<sup>th</sup> ORPHEUS Conference

-

## Creating Career Opportunities for PhDs in Life and Health Sciences

April, 3<sup>rd</sup>-5<sup>th</sup> 2014

University Hospital (CHUV), Lausanne, Switzerland

Website: [www.unil.ch/orpheus2014](http://www.unil.ch/orpheus2014)



**9<sup>th</sup> ORPHEUS Conference: An International Congress on PhD Education**  
Lausanne, Switzerland, April 3<sup>rd</sup>-5<sup>th</sup> 2014 at the University Hospital (CHUV)

Dear Participant,

The Faculty of Biology and Medicine of the University of Lausanne (UNIL-FBM) and the University Hospital of Lausanne (CHUV) have the great pleasure to welcome you to the 9<sup>th</sup> ORPHEUS Conference.

The 9<sup>th</sup> edition will address an issue which is bound to shape postgraduate studies in the coming decade: Creating Career Opportunities for PhDs in Life and Health Sciences. PhD graduates tend to engage in careers in various fields such as academic research, industry, international and/or non-governmental organisations, hospitals, museums, journalism and public administration, just to name a few. It is therefore of major importance that PhD candidates are trained and made aware of upcoming career opportunities.

**A Focus on Careers**

The program focuses on careers in Life and Health Sciences and includes several partners from and outside academia to share their experience, expectations and possibilities of collaborating toward PhD training. During the Life Science Career Day satellite event, PhD candidates, undergraduate students and post-doctoral fellows together with scientists, will have the chance to discuss their professional experiences within a broad range of fields.

**Developing Programs in an International Context**

The career issue cannot be dissociated from an international context. Scientists tend to create international synergies and evolve outside of their country of origin. This is why PhD programs should benefit from being developed and harmonized on an international scale.

**PhD Supervision**

An oral session and workshop are dedicated to PhD supervision. The role of supervisors is very demanding as they are not only scientists and team leaders, but also teachers and mentors. Thesis directors, PhD candidates and experts will express their opinion and present concrete actions on specific problems that may arise during PhD supervision.

**ORPHEUS Mundus**

This year, more than 40 countries and 100 institutions are represented. Whilst going to press, close to 300 participants from Australia, Austria, Belgium, Bosnia and Herzegovina, Bulgaria, Canada, China, Croatia, Czech Republic, Denmark, Estonia, Finland, France, Georgia, Germany, Hungary, Iceland, Ireland, Italy, Jordan, Kazakhstan, Latvia, Lithuania, Luxembourg, Netherlands, Norway, Poland, Portugal, Romania, Russia, Saudi Arabia, Serbia and Montenegro, Singapore, Slovakia, Slovenia, Spain, Sweden, Switzerland, Turkey, Ukraine, United Kingdom and the United States have registered. In addition, the satellite event on Life Science Careers is fully booked with an attendance of 500 young scientists.

We welcome you to the 9<sup>th</sup> edition of the ORPHEUS conference and we appreciate your active contribution to the improvement of PhD education.

Prof. Stephanie Clarke

President of the ORPHEUS 2014  
Local Organising Committee &  
Director of the Doctoral School FBM,  
University of Lausanne  
UNIL-FBM

Prof. Pierre-François Leyvraz

General Director of the  
University Hospital of Lausanne  
CHUV

Prof. Béatrice Desvergne

Dean of the Faculty of Biology and Medicine,  
University of Lausanne  
UNIL-FBM

# TABLE OF CONTENTS

<b>C</b> OMMITTEES.....	3-4
• LOCAL ORGANISING COMMITTEE.....	3
• INTERNATIONAL SCIENTIFIC COMMITTEE.....	4
<b>G</b> ENERAL INFORMATION.....	5-6
<b>S</b> CIENTIFIC PROGRAM.....	7-13
• THURSDAY, 3 <sup>RD</sup> OF APRIL 2014.....	7-8
• FRIDAY, 4 <sup>TH</sup> OF APRIL 2014.....	9-12
• SATURDAY, 5 <sup>TH</sup> OF APRIL 2014.....	13
<b>S</b> Ocial PROGRAM.....	14
<b>M</b> AP OF AUDITORIUMS.....	15

## Local Organising Committee (LOC) for ORPHEUS 2014

### The Heads and Representatives of the PhD programs

*At the UNIL-FBM-CHUV and other Institutions in Switzerland*

Prof. Stephanie Clarke (Director of the Doctoral School, LOC President)  
 Prof. Béatrice Desvergne (Dean)  
 Prof. Pierre-André Michaud (Vice-Dean for Academic Programs)  
 Prof. Diane Morin (Director, Institute of Higher Education and Nursing Research)  
 Prof. Fred Paccaud (Director, Swiss School of Public Health+)  
 Dr. Denis Billotte (General Secretary, Western Switzerland University Conference)  
 Prof. Jean-Pierre Hornung (Director, Lemanic Neuroscience Doctoral School)  
 Prof. Daniel Hohl (Director, MD-PhD Program)  
 Prof. Stefan Kunz (Director, PhD Program in Microbial Sciences)  
 Prof. Nouria Hernández (Director, PhD Program in Integrated Experimental and Computational Biology)  
 Prof. Paolo Dotto (Director, PhD Program in Cancer and Immunology)  
 Dr. Ulrike Toepel (Coordinator, PhD Program Cardiovascular and Metabolism)

### The Association of PhD Candidates and Assistants (ADAS)

*At the UNIL-FBM*

Ms. Natalie Neubert  
 Ms. Layane Hanna-El-Daher  
 Mr. Omayya Dudin  
 Ms. Mélanie Juilland  
 Mr. Mati Moyat  
 Mr. Ludovic Pilloux  
 Ms. Sarah Vacle

### The Doctoral School Team

Dr. Laura De Santis (Conference Coordinator, PhD Program in Life Sciences)  
 Dr. Slavica Masina (Conference Coordinator)  
 Ms. Chloé Arnera (Communications Assistant)  
 Ms. Aniko Fehr (Conference Assistant)

### Under the Patronage of

Prof. Peter Meier-Abt, President, Swiss Academy of Medical Sciences  
 Prof. Thierry Courvoisier, President, Swiss Academy of Sciences  
 Prof. Dieter Imboden, Past President, Swiss National Science Foundation

#### Abbreviations:

CHUV University Hospital of Lausanne  
 CUSO Western Switzerland University Conference  
 FBM Faculty of Biology and Medicine  
 IUFRS Institute of Higher Education and Nursing Research  
 SSPH+ Swiss School of Public Health  
 UNIL University of Lausanne

### ORPHEUS Executive Committee

Prof. Zdravko Lacković (President, Croatia)  
Prof. Michael Mulvany (Vice President, Denmark)  
Prof. Seppo Meri (General Secretary, Finland)  
Prof. Andrea Olschewski (Treasurer, Austria)  
Dr. Veronika Marlies Berghold, PhD Candidate (Austria)  
Prof. Miroslav Cervinka (Czech Republic)  
Prof. Stephanie Clarke (Switzerland)  
Prof. Simona Dragan (Romania)  
Prof. Gül Güner-Akdoğan (Turkey)  
Prof. Konstantin Gurevich (Russia)  
Prof. Roland Jonsson (Norway)  
Prof. André Nieoullon (France)  
Prof. Chris Van Schravendijk (Belgium)

### Co-opted Members of the ORPHEUS Executive Committee

Prof. Ana Borovečki (Croatia)  
Dr. Debora Grosskopf-Kroiher (Germany)  
Prof. Robert Harris (Sweden)  
Prof. Luis Martínez Millán (Spain)



## About Lausanne

In the heart of Europe, the capital city of the Vaud canton is located between the Geneva Lake and the Alps, surrounded by the Lavaux vineyards with breathtaking landscapes.

Fourth largest city of Switzerland, Lausanne distinguishes itself as the Olympic City and a renowned place for high quality education and culture. As a well-linked tourist destination, the city also boasts a high standard of living and economic attractiveness. Lausanne accommodates the headquarters of several multinationals, universities, renowned research centers, dozens of international sporting federations, as well as numerous cultural institutions. Lausanne is particular for its dynamism, its capacity to innovate and the diversity of its tourist attractions.

More information available at: [www.lausanne-tourisme.ch](http://www.lausanne-tourisme.ch)

## About UNIL-FBM

The Faculty of Biology and Medicine (FBM) was created in 2003, by merger of the biology section from the former Faculty of Science and the Faculty of Medicine. This combination created a unique training base in Switzerland that focuses on Life Sciences. Simultaneously, three schools were created: the School of Biology, the School of Medicine and the Doctoral School. The Schools of Biology and Medicine are responsible for the Bachelor and Master levels of training, and the Doctoral School is responsible for post-graduate training, i.e. PhD, MD-PhD and MD.

Teaching in the disciplines of biology and medicine also offers many possibilities for close collaboration between the Faculty and the University Hospital. The Faculty of Biology and Medicine is committed to excellence in research and in teaching, working across traditional disciplinary boundaries. The partnership between the Faculty and the University Hospital, together with collaborations within the University of Lausanne and the Swiss Federal Institute of Technology (EPFL), offer unique opportunities for interdisciplinary research, development of new technologies and translational research.

More information available at: [www.unil.ch/fbm](http://www.unil.ch/fbm) and [www.unil.ch/ecoledoctoralefbm](http://www.unil.ch/ecoledoctoralefbm)

## About the CHUV

The *Centre Hospitalier Universitaire Vaudois* (CHUV) is the University Hospital of the canton of Vaud. It is one of the largest hospitals in Switzerland and has an international reputation for excellence. It serves as a hospital offering general care for the whole population of the French-speaking part of Switzerland.

The University Hospital has a leading role in several fields such as burns, organ transplants, oncology, AIDS, neuroscience and in clinical trials of new therapies in Europe and the world.

Thanks to its collaboration with the Faculty of Biology and Medicine from the University of Lausanne, the CHUV plays a key part on a European scale in the field of research and training.

More information available at: [www.chuv.ch](http://www.chuv.ch)

## Access to the Conference Venue

The University Hospital (CHUV) is easily accessible by metro. The m2 metro line trip from the train station «Lausanne Gare» to the «CHUV» station takes only 8 minutes and a one hour-ticket that covers the inner city zone costs CHF 3.50. All the conference hotels are situated in the city center, close to an m2 station, and offer to their clients a free public transport card for the duration of their stay.

By car, on the A1 motorway (Switzerland's main east-west axis), take the «Lausanne-Vennes/Hôpitaux» exit. Use the car park (called Park&Ride) at the «Vennes» m2 stop. Then take the m2 to the «CHUV» stop (this journey takes 5 minutes).

More information available at: [www.unil.ch/orpheus2014](http://www.unil.ch/orpheus2014)

# GENERAL INFORMATION

## Fees Include

For Participants:

- Participation to all sessions and the poster presentations
- Program and conference proceedings
- Lunch
- Coffee and refreshments
- Welcome aperitif
- Gala dinner
- For PhD candidates only: PhD Candidates' Night

For Accompanying Persons:

- Opening Ceremony
- Welcome aperitif
- Gala dinner

## Conference Welcome Desk

The welcome desk is located in front of the Alexandre Yersin Auditorium. Each participant is invited to announce themselves in person to receive their badge and conference documents.

The desk is open at the following times:

**Thursday, April 3<sup>rd</sup>:** 9<sup>00</sup>-18<sup>00</sup>

**Friday, April 4<sup>th</sup>:** 8<sup>00</sup>-17<sup>00</sup>

**Saturday, April 5<sup>th</sup>:** 8<sup>15</sup>-17<sup>00</sup> (for the Life Science Careers Satellite Event)

Registration on-site is possible on Thursday and Friday. Please note that on-site registrations have to be paid in Swiss francs, in cash (exact amount) or by Visa/Mastercard.

In case of any questions do not hesitate to ask the University of Lausanne staff at the ORPHEUS welcome desk or to send an e-mail to: [orpheus2014@unil.ch](mailto:orpheus2014@unil.ch).

## Abstract Book

The abstract book is available at the conference website. You can download it on your iPhone, iPad or laptop via the free Wi-Fi connection available on the conference venue.

Download your abstract book at: [www.unil.ch/orpheus2014](http://www.unil.ch/orpheus2014)

## Posters

Posters will be on display in the poster zone (see map on page 15).

**Poster presentations will take place on Friday the 4<sup>th</sup> of April, from 12<sup>00</sup> to 14<sup>00</sup>, simultaneously with the lunch break. Please be present in front of your poster during this period. Please note that posters should be removed by 15<sup>30</sup> the latest on Friday afternoon.**

## Important Phone Numbers

- Lausanne Tourism Office : +41 (0)21 613 73 73
- Hotel Booking (if you booked your room via the Lausanne Tourism Office): +41 (0)21 613 73 14
- Taxi Lausanne: +41 (0)844 814 814 or +41 (0)844 810 810
- Emergency Numbers: Ambulance, 144 / Police, 117 / Fire service, 118

## Satellite Event: Life Science Career Day

Participants that also registered for the satellite event on Life Science Careers should present themselves at the welcome desk (8<sup>15</sup>-9<sup>00</sup>) on Saturday 5<sup>th</sup> of April to collect their badges and program.

More information available at: [www.unil.ch/lifesciencecareerday](http://www.unil.ch/lifesciencecareerday)

The Satellite Event is organised by the Faculty of Biology and Medicine (School of Biology and Doctoral School), the Lemanic Neuroscience Doctoral School and the Bioscience Network Lausanne.

9<sup>00</sup>-18<sup>00</sup> Registration

11<sup>00</sup>-14<sup>00</sup> **PhD Candidates' Pre-Conference Workshop:  
Improve Biomedical PhD Programs for Non-Academic Careers**

(Alexandre Yersin Auditorium)

**Attendance reserved to PhD Candidates**

- Dr. Denis Billotte  
General Secretary, Western Switzerland University Conference (CUSO),  
Neuchâtel, Switzerland
- Ms. Christa Janko  
European Medicines Research Training Network (EMTRAIN),  
Medical University, Vienna, Austria
- Mr. Reto Hartmann  
Business Consultant, Platinn Innovation Platform, Lausanne, Switzerland

Chairs: Dr. Veronika Berghold (ORPHEUS Executive Committee, Austria)  
Mr. Gergely Fügedi (Semmelweis University, Budapest, Hungary)  
Ms. Natalie Neubert (University of Lausanne, Switzerland)

**This workshop is supported by the Association of PhD Candidates and Assistants (ADAS) at the UNIL-FBM**

15<sup>00</sup>-15<sup>45</sup> **Opening Ceremony**

(César Roux Auditorium)

(Please note that the order of speakers for the Opening Ceremony may slightly change.)

- Prof. Stephanie Clarke, President of the Local Organising Committee, Switzerland
  - Prof. Dominique Arlettaz, Rector of the University of Lausanne, Switzerland
  - Prof. Pierre-François Leyvraz, Director of the University Hospital, Switzerland
  - Prof. Béatrice Desvergne, Dean of the Faculty of Biology and Medicine, University of Lausanne, Switzerland
  - Mr. Pierre-Yves Maillard, President of the Canton de Vaud and Head of the Department of Health and Social Action, Switzerland
  - Prof. Zdravko Lacković, President of the ORPHEUS Executive Committee, Croatia
- ORPHEUS 10 Year Anniversary and Beyond*

Chairs: Prof. Stephanie Clarke (President of the Local Organising Committee)  
Prof. Zdravko Lacković (President of the ORPHEUS Executive Committee)

15<sup>45</sup>-16<sup>15</sup>

## Opening Plenary Lecture

(César Roux Auditorium)

- Dr. Helke Hillebrand  
Academic Coordinator and Dean of Graduate Studies, European Molecular Biology Laboratory (EMBL) International PhD Program, Heidelberg, Germany  
*Trade-mark, Tradition and Plasticity: Cornerstones for PhD Education in the 21<sup>st</sup> Century*

Chairs: Dr. Edwin Kroeger (University of Manitoba, Canada)  
Prof. Pierre-André Michaud (University of Lausanne, Switzerland)

16<sup>15</sup>-16<sup>45</sup>

Coffee Break

16<sup>45</sup>-18<sup>15</sup>

## Session I: PhDs around the World

(César Roux Auditorium)

16<sup>45</sup>-17<sup>15</sup>

- Prof. Wang Qing  
Vice-Dean of the Graduate School, Peking University Health Science Center, Beijing, China  
*Education of Biomedical PhD Programs in Peking University*

17<sup>15</sup>-17<sup>45</sup>

- Dr. Wen Bin Lai  
Director of the Research office, National University Health System (NUHS), Singapore  
*PhD Education and Career Opportunities in the Field of Life and Health Sciences in Singapore*

17<sup>45</sup>-18<sup>15</sup>

- Prof. Nick Goulding  
Director of Education, William Harvey Research Institute, London, United Kingdom  
*The UK Biomedical PhD under the Microscope*

Chairs: Prof. Joey Barnett (Vanderbilt University, USA)  
Prof. Philippe Moreillon (University of Lausanne, Switzerland)

18<sup>15</sup>-20<sup>00</sup>

Welcome Aperitif (Conference Hall)

20<sup>00</sup>-24<sup>00</sup>

PhD Candidates' Night

PhD Candidates are invited to attend the party by the Doctoral School of the Faculty of Biology and Medicine.

8<sup>00</sup>-17<sup>00</sup> Registration

8<sup>30</sup>-9<sup>00</sup> **Plenary Lecture II**

(César Roux Auditorium)

- Prof. David Gordon  
President-Elect, World Federation for Medical Education, University of Copenhagen, Denmark  
*Is the Making of Standards like "the Making of Shoes"?*

Chairs: Prof. Vladimir Bumbasirevic (University of Belgrade, Serbia)  
Prof. Miroslav Cervinka (ORPHEUS Executive Committee, Czech Republic)  
Prof. Winship Herr (University of Lausanne, Switzerland)

9<sup>00</sup>-10<sup>15</sup> **Session II: PhDs around Health Sciences**

(César Roux Auditorium)

- 9<sup>00</sup>-9<sup>25</sup>
- Prof. Sabina De Geest

Director, Institute of Nursing Science of the University of Basel, Switzerland  
*Developing an Educational Infrastructure for Doctoral Studies in Nursing Science at the University of Basel in Switzerland*

- 9<sup>25</sup>-9<sup>50</sup>
- Prof. Stuart Anderson

Associate Dean of Studies, London School of Hygiene and Tropical Medicine, United Kingdom  
*Training Researchers, Developing Leaders: New Approaches to Doctoral Education in Public Health*

- 9<sup>50</sup>-10<sup>15</sup>
- Prof. Jean-Pierre Hornung

Director, Lemanic Neuroscience Doctoral School, University of Lausanne  
Former Chair, Network of European Neuroscience Schools (NENS) Committee, Switzerland  
*PhD Programs in Neuroscience : Structures and Challenges in Switzerland and in Europe*

Chairs: Prof. Roland Jonsson (ORPHEUS Executive Committee, Norway)  
Prof. Fred Paccaud (Swiss School of Public Health+, Switzerland)

10<sup>15</sup>-10<sup>45</sup> Coffee Break

10<sup>45</sup>-12<sup>00</sup> **Session III: Quality of PhD Supervision**

(César Roux Auditorium)

10<sup>45</sup>-11<sup>10</sup>

- Prof. Gitte Wichmann-Hansen  
Centre for Teaching and Learning, Aarhus University, Denmark  
*Quality in the PhD Process*

11<sup>10</sup>-11<sup>35</sup>

- Prof. Robert Harris  
Director, Doctoral Education of the Karolinska Institute, Stockholm, Sweden  
*Outcome Based Doctoral Education*

11<sup>35</sup>-12<sup>00</sup>

- Dr. Veronika Berghold  
PhD Candidate, PhD in Molecular Medicine, Medical University of Graz, Austria  
*PhD Supervision across Europe and Beyond: From the PhD Candidates' Perspective*

Chairs: Dr. Mélanie Bosson (University of Lausanne, Switzerland)  
Mr. Ewoud Compeer (Utrecht University, Netherlands)

12<sup>00</sup>-14<sup>00</sup>

Lunch and Posters

14<sup>00</sup>-15<sup>00</sup>

**Session IV: Free Communications**

(César Roux Auditorium)

14<sup>00</sup>-14<sup>15</sup>

- Prof. Francesco Saverio Ambesi-Impiombato  
University of Udine, Italy  
*SITT (Selection Improvement Topical Team) Model to Study the Influence of the Admission Procedure on the PhD Program Outcomes*

14<sup>15</sup>-14<sup>30</sup>

- Prof. Miroslav Cervinka  
Charles University in Prague, Czech Republic  
*Open Access – The Way Towards International Harmonization in PhD Training*

14<sup>30</sup>-14<sup>45</sup>

- Prof. Nino Chikhladze<sup>1</sup> & Ms. Natia Skhvitaridze<sup>2</sup>  
Ivane Javakhishvili Tbilisi State University, Georgia (TSU)<sup>1</sup>  
University of Georgia (UG)<sup>2</sup>  
*Modernizing PhD Programs in the Framework of the SIU Project through Collaboration with University of Tromsø: TSU and UG Experience*

14<sup>45</sup>-15<sup>00</sup>

- Prof. Oksana Sulaieva  
M. Gorky Donetsk National Medical University, Ukraine  
*Achieving of ORPHEUS Standards in Ukraine: Illusion or Reality?*

Chairs: Prof. Luis Martínez Millán (ORPHEUS Executive Committee, Spain)  
Prof. Radu Oprean (Iuliu Hatieganu University, Cluj-Napoca, Romania)  
Mr. Ludovic Pilloux (University of Lausanne, Switzerland)

15<sup>00</sup>-15<sup>30</sup>

Coffee Break

15<sup>30</sup>-17<sup>00</sup>

### Parallel Workshops

#### **1. Public-Private Partnership PhDs and Employability** (Alexandre Yersin Auditorium)

- Dr. Johannes Mosbacher  
Head Cellular Neuroscience, F. Hoffmann-Roche Ltd, Basel, Switzerland
- Dr. Mike Hardman  
EMTRAIN, VP Science Relations, AstraZeneca, Macclesfield, United Kingdom
- Prof. Anita Aperia  
EMTRAIN, Professor of Pediatrics, Karolinska Institute, Stockholm, Sweden

Chairs: Mr. Omayya Dudin (University of Lausanne, Switzerland)  
Dr. Debora Grosskopf-Kroiher (ORPHEUS Executive Committee, Germany)  
Ms. Christa Janko (EMTRAIN, Medical University of Vienna, Austria)

#### **2. PhD Supervision & Career Mentoring** (Auguste Tissot Auditorium)

- Prof. Charlotte Braun-Fahrländer  
Academic Director and Head of the PhD Program "Public Health",  
Swiss School of Public Health+, Basel, Switzerland
- Prof. Robert Harris  
Director, Doctoral Education of the Karolinska Institute, Stockholm, Sweden

Chairs: Dr. Altyn Aringazina (Kazakhstan School of Public Health, Kazakhstan)  
Ms. Layane Hanna-El-Daher (University of Lausanne, Switzerland)

#### **3. PhD Education and Careers in Nursing** (Charlotte Olivier Auditorium)

- Prof. Judith Shamian  
President, International Council of Nurses, Geneva, Switzerland
- Prof David Richards  
President, European Academy of Nursing Science, University of Exeter, United Kingdom

Chairs: Mr. Andrew Dwyer (University Hospital of Lausanne, Switzerland)  
Prof. Gül Güner-Akdoğan (ORPHEUS Executive Committee, Turkey)  
Prof. Diane Morin (University Hospital of Lausanne, Switzerland)  
Dr. Venetia Velonaki (University Hospital of Lausanne, Switzerland)

Workshop n°1 is supported by : The European Medicines Research Training Network (EMTRAIN), Austria  
Workshop n°2 is supported by : The Swiss School of Public Health (SSPH+), Switzerland  
Workshop n°3 is supported by : The Institute of Higher Education and Nursing Research, University of Lausanne, Switzerland  
The Institute of Nursing Science, University of Basel, Switzerland

## 4. **ORPHEUS Labelling** (Mathias Mayor Auditorium)

- Prof. Mirecka Jadwiga  
Executive Committee of the Association for Medical Education in Europe (AMEE),  
Krakow, Poland
- Dr. Helke Hillebrand  
Academic Coordinator and Dean of Graduate Studies, EMBL International PhD Program,  
Heidelberg, Germany
- Prof. Zdravko Lacković  
President of the ORPHEUS Executive Committee, Zagreb, Croatia
- Prof. Tatjana Simić  
Vice-Dean of the Medicine School, University of Belgrade, Serbia
- Prof. André Nieoullon  
Director of the Doctoral School, University of Marseille, France
- Dr. Veronika Berghold  
PhD Candidate Representative of the ORPHEUS Executive Committee, Graz, Austria
- Prof. Michael Mulvany  
Vice President of the ORPHEUS Executive Committee, Aarhus, Denmark

Chairs: Prof. Mirecka Jadwiga (AMEE Executive Committee, Poland)  
Prof. Michael Mulvany (ORPHEUS Executive Committee, Denmark)

17<sup>00</sup>-18<sup>15</sup>

## **Session V: Responsible Conduct in Research**

(César Roux Auditorium)

17<sup>00</sup>-17<sup>20</sup>

- Prof. Lazare Benaroyo  
President, Ethos – Interdisciplinary Ethics Platform, University of Lausanne, Switzerland  
*Ethics and Research: What Does it Mean to be Responsible?*

17<sup>20</sup>-17<sup>40</sup>

- Prof. Christiane Woopen  
Chair, German Ethics Council, Director of CERES (Cologne Center for Ethics, Rights,  
Economics and Social Sciences of Health) and Head of Research Unit Ethics, Germany  
*Sensitising for Ethical Implications*

17<sup>40</sup>-18<sup>00</sup>

- Prof. Henk ten Have  
Director, McAnulty College and Graduate School of Liberal Arts Center for Healthcare  
Ethics, University of Duquesne, Pittsburgh, PA, USA  
*Responsible Conduct in Research*

18<sup>00</sup>-18<sup>15</sup>

Discussion

Chairs: Dr. Ana Borovečki (ORPHEUS Executive Committee, Croatia)  
Ms. Ruta Vosyliute (Lithuanian University of Health Sciences, Lithuania)  
Prof. Lise Wogensen Bach (Aarhus University, Denmark)

19<sup>30</sup>-23<sup>00</sup>

Gala Dinner at the «Restaurant de Dorigny»  
(University Restaurant, Campus of the University of Lausanne)



- 8<sup>15</sup>-17<sup>00</sup> **Satellite Event: Life Science Career Day** (César Roux Auditorium)
- 9<sup>00</sup>-9<sup>30</sup> **Plenary Lecture III**  
(Mathias Mayor Auditorium)
- Prof. Michael Mulvany  
Vice President of the ORPHEUS Executive Committee, Aarhus University, Denmark  
*Further Evolution of ORPHEUS Standards*
- Chairs: Prof. André Nieoullon (ORPHEUS Executive Committee, France)  
Prof. Zdravko Lacković (President of the ORPHEUS Executive Committee)
- 9<sup>30</sup>- 10<sup>30</sup> **Workshop Summaries and Round Table** (Mathias Mayor Auditorium)
- Moderators: Ms. Chiara Bellio (University of Padova, Italy)  
Prof. Roland Jonsson (ORPHEUS Executive Committee, Norway)  
Prof. Chris Van Schravendijk (ORPHEUS Executive Committee, Belgium)
- 10<sup>30</sup>-11<sup>00</sup> Coffee Break
- 11<sup>00</sup>-12<sup>00</sup> **Lausanne Consensus Statement** (Mathias Mayor Auditorium)
- Prof. Stephanie Clarke  
President of the Local Organising Committee, Lausanne, Switzerland
  - Prof. Michael Mulvany  
Vice President of the ORPHEUS Executive Committee, Aarhus University, Denmark
- Chairs: Dr. Veronika Berghold (ORPHEUS Executive Committee, Austria)  
Prof. Zdravko Lacković (President of the ORPHEUS Executive Committee)
- 12<sup>00</sup>-12<sup>30</sup> **Closing Speeches and Flag Ceremony** (Mathias Mayor Auditorium)
- Prof. Stephanie Clarke  
President of the Local Organising Committee 2014, Lausanne, Switzerland
  - Prof. Zdravko Lacković  
President of the ORPHEUS Executive Committee, Zagreb, Croatia
  - Prof. Vladimir Bumbasirevic  
President of the Local Organising Committee 2015, Belgrade, Serbia
- Chairs: Prof. Stephanie Clarke (President of the Local Organising Committee)  
Prof. Zdravko Lacković (President of the ORPHEUS Executive Committee)
- 13<sup>30</sup>-15<sup>00</sup> **ORPHEUS General Assembly** (Jequier Doge Auditorium - CHUV, PMU)

# SOCIAL PROGRAM

## Welcome Aperitif

On Thursday evening, all the participants are invited for a welcome aperitif in the main hall of the conference centre in front of the auditorium César Roux, CHUV.

## Gala Dinner

A gala dinner will take place at the «Restaurant de Dorigny» on the Campus of the University of Lausanne by the lake. Its friendly nickname, «Banane» (banana) is due to its curved and oblique shape. DJay Max, our invited artist - and also a researcher at the Department of Plant Molecular Biology (UNIL) - will add a magic touch of music to the evening.

## Access to the Gala Dinner

- Take the metro line 2 (m2) from the «CHUV» direction «OUCHY» and get out at «Lausanne FLON» (4<sup>th</sup> stop from the CHUV).
- Take the metro line 1 (m1) to «UNIL-Mouline» (7<sup>th</sup> stop from «Lausanne FLON»).
- The restaurant is a short 5min walk from the metro stop. There will be a University of Lausanne team to guide you.

**Use your free transport card for this journey (offered by your hotel if you booked your room via the Lausanne Tourism Office)!**

## PhD Candidates' Night

The Doctoral School and the Faculty of Biology and Medicine also invites all registered PhD candidates to take part in the PhD Candidates' Night, organised by ADAS, the Association of PhD Candidates and Assistants of our Faculty. The party will take place at the «ABC club», and includes finger food, drinks and a DJ.

## Access to the PhD Candidates' Night

- Take the metro line 2 (m2) from the «CHUV» direction «OUCHY» and get out at «Lausanne FLON» (4<sup>th</sup> stop from the CHUV).
- Walk towards and across «Place de l'Europe» where you will find the «D! Club» behind the big bridge.
- The «ABC club» is on the top floor of the «D! Club».

# CHUV Main Building, Entry Level

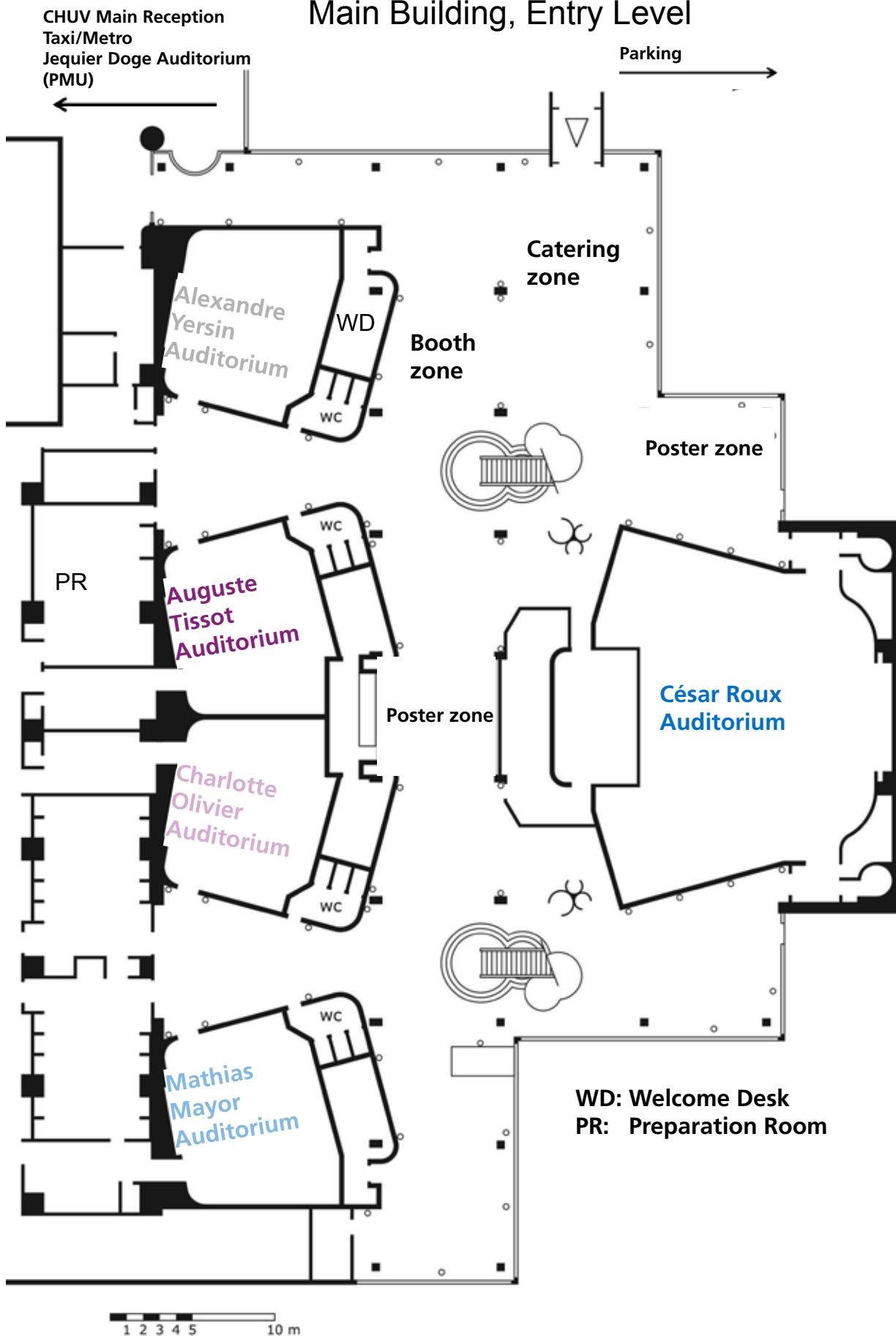

# PROGRAM AT A GLANCE

	Thursday, 3 <sup>rd</sup> of April	Friday, 4 <sup>th</sup> of April	Saturday, 5 <sup>th</sup> of April		
8 <sup>00</sup> -8 <sup>30</sup>			<b>Satellite Event on Life Science Careers</b> (8 <sup>15</sup> -17 <sup>00</sup> )		
8 <sup>30</sup> -9 <sup>00</sup>		Plenary Lecture II			
9 <sup>00</sup> -9 <sup>30</sup>		Session II: PhDs around Health Sciences	Plenary Lecture III		
9 <sup>30</sup> -10 <sup>00</sup>			Workshops Summaries & Round Table		
10 <sup>00</sup> -10 <sup>30</sup>		Coffee Break			
10 <sup>30</sup> -11 <sup>00</sup>			Coffee Break		
11 <sup>00</sup> -11 <sup>30</sup>	PhD Candidates' Pre-Conference Workshop	Session III: Quality of PhD Supervision	Lausanne Consensus Statement		
11 <sup>30</sup> -12 <sup>00</sup>					
12 <sup>00</sup> -12 <sup>30</sup>			Lunch & Posters (Main hall)	Closing Speeches & Flag Ceremony	
12 <sup>30</sup> -13 <sup>00</sup>					
13 <sup>00</sup> -13 <sup>30</sup>					
13 <sup>30</sup> -14 <sup>00</sup>					
14 <sup>00</sup> -14 <sup>30</sup>		Session IV: Free Communications	ORPHEUS General Assembly (Jequier Doge Auditorium)		
14 <sup>30</sup> -15 <sup>00</sup>					
15 <sup>00</sup> -15 <sup>30</sup>	Opening Ceremony	Coffee Break			
15 <sup>30</sup> -16 <sup>00</sup>	Opening Plenary Lecture	<b>Parallel Workshops</b> 1. Public-Private Partnership 2. PhD Supervision 3. Education & Careers in Nursing 4. ORPHEUS Labelling			
16 <sup>00</sup> -16 <sup>30</sup>	Coffee Break				
16 <sup>30</sup> -17 <sup>00</sup>					
17 <sup>00</sup> -17 <sup>30</sup>	Session I: PhDs around the World		Session V: Responsible Conduct in Research		
17 <sup>30</sup> -18 <sup>00</sup>					
18 <sup>00</sup> -18 <sup>30</sup>			<b>Legend :</b> César Roux Auditorium Alexandre Yersin Auditorium Auguste Tissot Auditorium Charlotte Olivier Auditorium Mathias Mayor Auditorium  Refer to detailed map of auditoriums on the reverse side of this page.		
18 <sup>30</sup> -19 <sup>00</sup>	Welcome Aperitif (Main hall)				
19 <sup>00</sup> -19 <sup>30</sup>					
19 <sup>30</sup> -20 <sup>00</sup>					
20 <sup>00</sup> -20 <sup>30</sup>		Gala Dinner (UNIL Campus by the Lake Lemman)			
20 <sup>30</sup> -21 <sup>00</sup>	PhD Candidates' Night (ABC club, Lausanne city centre)				
21 <sup>00</sup> -23 <sup>00</sup>					